

Freestanding Designer Fireplace

ecosmar<sup>+</sup>  
Fire

# Ghost



**YARDART** [info@yardart.com](mailto:info@yardart.com)

995 Governor Dr. #103  
El Dorado Hills, CA 95762

866 382-8600

# Ghost Design features

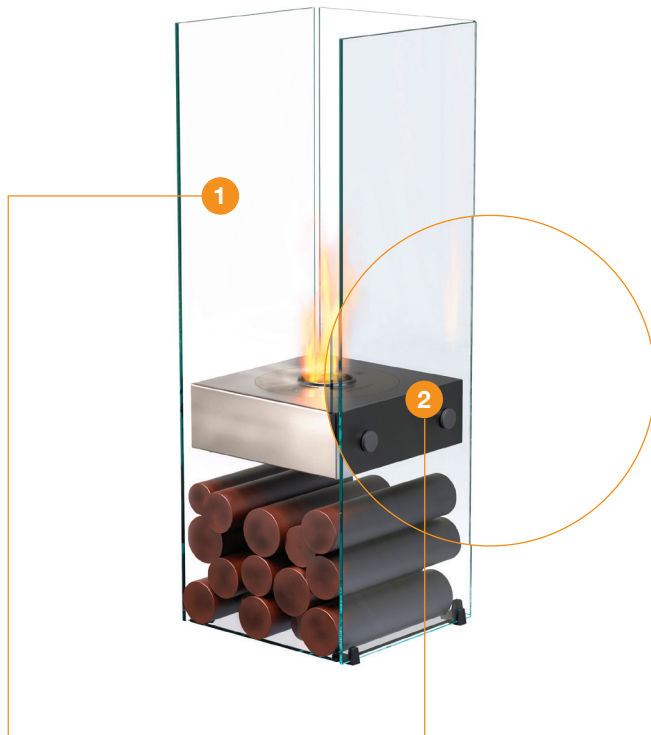

## 1. Glass Surround

Made with Toughened Glass.

## No Flue, No Chimney, No Electricity Connection

Our freestanding fireplaces offer an easy and immediate, environmentally friendly solution to adding warmth and ambiance to any location.

## Quick and Easy Installation

With no installation or building works required, simply unpack, put into position, and off you go.

## 2. Colours

Burner Shelf and Burner come in Stainless Steel and Black.

## Portable Fireplace

Fully portable, you can move the fireplace between rooms and outdoor spaces, or store away when not needed.

## Environmentally-Friendly

Bioethanol fireplaces use an environmentally-friendly, renewable energy source that burns clean and delivers warming heat. You and your guests will enjoy the ambiance and tranquility of a real fire, without the hassles of burning real wood - no more embers, ash, and soot to clean up.

## Global Compliance

This model complies with existing standards in the USA, Europe, UK and Australia. O-TL listed to UL 1370, EN 16647 BSI Certified and ACCC Safety Mandate compliant.

*\*Decorative logs must NOT be placed directly over an open flame. They are designed to sit near heat but not over flames.*

## Included Accessories



Jerry Can with Safety Spout  
& e-NRG bottle adaptor



Lighting Rod & Lighter



Jerry Can Spout Extension

## Optional Accessories



Ghost Fire Screen









Decorative Steel Logs\*

Disclaimer: All product specifications and data are subject to change without notice and believed to be correct at the time of publication. MAD Design Group (MDG), its affiliates, agents, and employees, and all persons acting on its or their behalf (collectively, "MAD Design Group"), disclaim any and all liability for any errors, inaccuracies or incompleteness contained herein or in any other disclosure relating to any product. MDG disclaims any and all liability arising out of the use or application of any product described herein or of any information provided herein to the maximum extent permitted by law. The product specifications do not expand or otherwise modify MDG's terms and conditions of purchase, including but not limited to the warranty expressed therein, which apply to these products. No license, express or implied, by estoppel or otherwise, to any intellectual property rights is granted by this document or by any conduct of MDG. Customers using or selling MDG products not expressly indicated for use in such applications do so entirely at their own risk and agree to fully indemnify MDG for any damages arising or resulting from such use or sale. Please contact authorised personnel from MDG to obtain written terms and conditions regarding products designed for such applications. Images are indicative only.

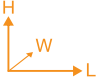
# Ghost Specifications

An elegant, freestanding fireplace, Ghost is constructed from glass and steel. It's slim-line shape means it perfectly complements residential and commercial spaces.

Burner Ventilation and Efficiency\*

						
Dimensions L x W x H mm/in	Compatible Burner	Fuel Capacity	Heats on Average (Indoors)	Thermal Output Net (MAX)	Approx. Burn Time	Minimum Room Size
400 x 386 x 1106 15.7 x 15.2 x 19.8	AB3	2.5 L [0.7 Gals]	Over 20 m <sup>2</sup> [215 ft <sup>2</sup> ]	6.14 MJ/h 5,800 BTU/h 1.7 kW	8 - 11 hours	40 m <sup>3</sup> [1,413 ft <sup>3</sup> ]

Application	Indoor Only
Surround Colours	 Stainless Steel ESF.D.GST  Black ESF.D.GST.BL
Burner Colours	 Stainless Steel  Black
Materials	Grade 304 Stainless Steel, Black High-temp Coated Stainless Steel, Toughened Glass, Grade 304 Stainless Steel Burner, with optional Black Ceramic Coating
Approx. Weight	35.6kg [78.2lbs] Weight includes burner.
Fuel Type	e-NRG Bioethanol / <b>e-NRG.com</b>

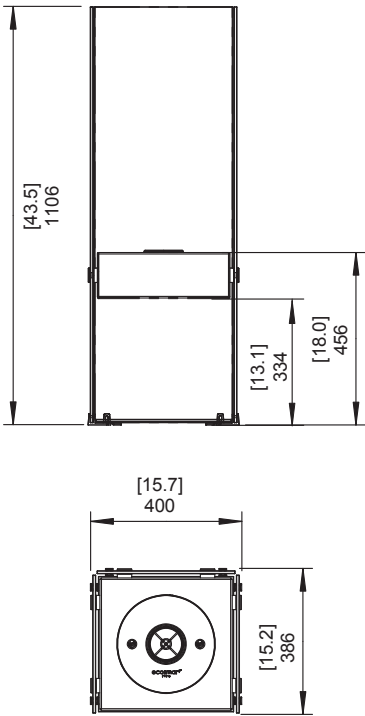

\*These values are indicative only and may vary depending on the model purchased, installation, and the seasonal resource used to manufacture e-NRG.  
Decorative logs must NOT be placed directly over an open flame. They are designed to sit near heat but not over flames. (Logs not included).  
This model comes with fixing brackets for permanently locating into a fixed position.  
This model complies with existing standards in the USA, Europe, UK and Australia. O-TL listed to UL 1370, EN 16647 BSI Certified and ACCC Safety Mandate compliant.

FOR MORE INFORMATION PLEASE REFERENCE THE CLEARANCE & INSTALLATION MANUAL

Disclaimer. All product specifications and data are subject to change without notice and believed to be correct at the time of publication. MAD Design Group (MDG), its affiliates, agents, and employees, and all persons acting on its or their behalf (collectively, "MAD Design Group"), disclaim any and all liability for any errors, inaccuracies or incompleteness contained herein or in any other disclosure relating to any product. MDG disclaims any and all liability arising out of the use or application of any product described herein or of any information provided herein to the maximum extent permitted by law. The product specifications do not expand or otherwise modify MDG's terms and conditions of purchase, including but not limited to the warranty expressed therein, which apply to these products. No license, express or implied, by estoppel or otherwise, to any intellectual property rights is granted by this document or by any conduct of MDG. Customers using or selling MDG products not expressly indicated for use in such applications do so entirely at their own risk and agree to fully indemnify MDG for any damages arising or resulting from such use or sale. Please contact authorised personnel from MDG to obtain written terms and conditions regarding products designed for such applications. Images are indicative only.